

**BC LAND SURVEYORS SITE PLAN OF:**

**Civic: 1085 & 1093 Gosper Crescent**

Legal – Lots A, B and C, Section 10,  
Esquimalt District, Plan EPP106570

File : 13068 – 35  
V.I. POWELL & ASSOCIATES  
Land Surveying  
250-2950 Douglas Street  
Victoria, BC V8T 4N4  
phone (250) 382-8855

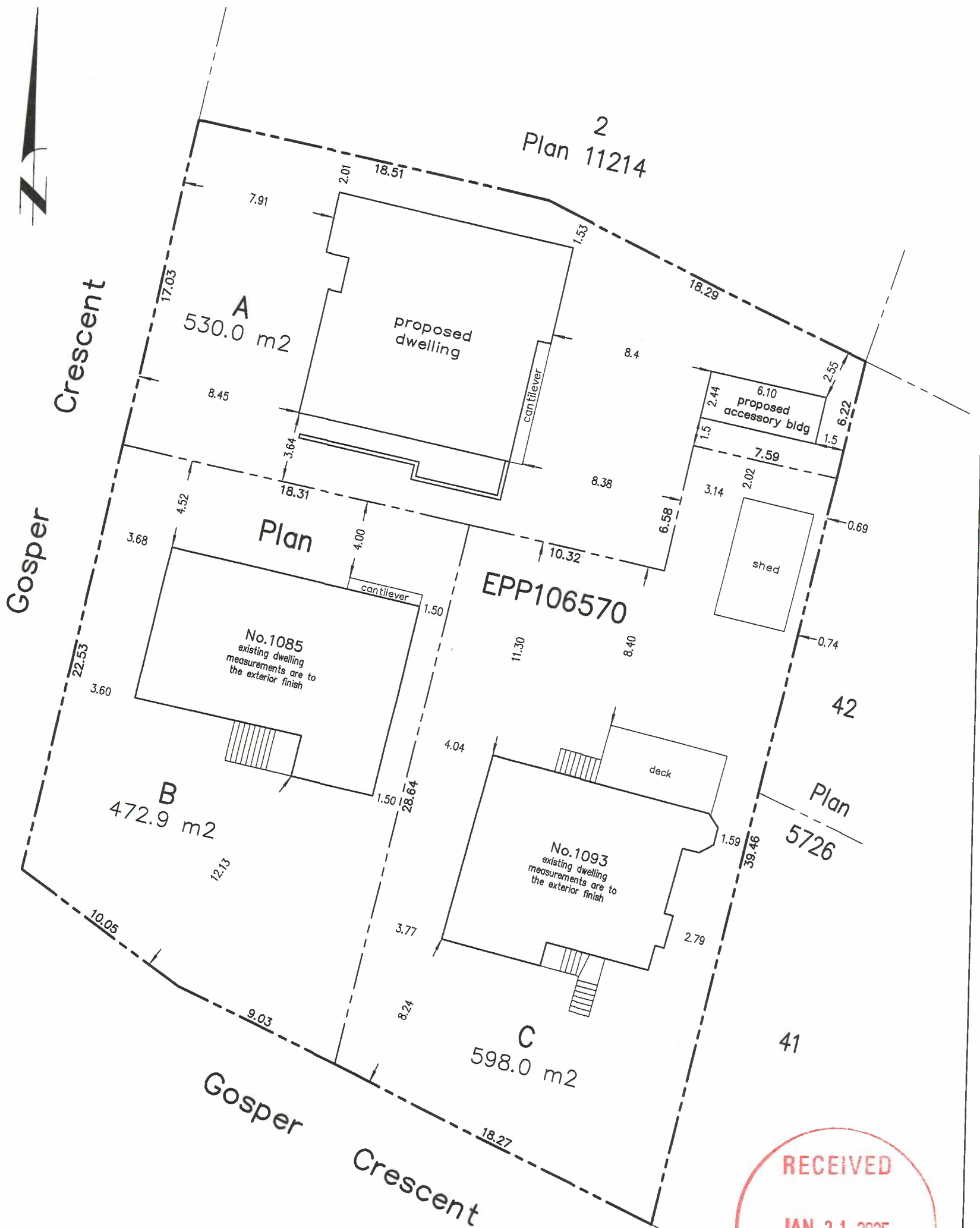

**CERTIFIED CORRECT**

This 3rd day of September, 2024.

Scott Thomas Pearse notarius  
Signed with Certifio (2024/09/03)  
Verify with verifio.com or Adobe Reader.

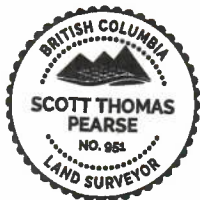

Scott T. Pearse, BCLS ©

This document is not valid unless digitally signed and sealed.



Scale - 1 : 200 Distances are in metres.  
0 2 10 20

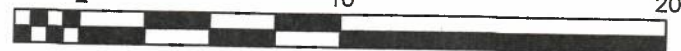

The intended print size is 11" by 17".